

SITE EXTENT (AS PER PATTI)

- 3350 SQ.M

ROAD AREA

- 867 SQ.M

TOTAL NO. OF PLOTS

- 8 Nos.

NOTE:

1. SPLAY - 1.5M x 1.5M
2. MEASUREMENTS ARE INDICATED EXCLUDING SPLAY DIMENSIONS
3. ROAD AREA WAS HANDED OVER TO THE LOCAL BODY

VIDE GIFT DEED DOCUMENT NO.16003/2019, DATED:14.11.2019, @ SRO AVADI.

CONDITION :

TNCDBR RULE No: 47 (11):

THE COST OF LAYING IMPROVEMENTS TO THE SYSTEMS IN RESPECT OF ROAD, WATER SUPPLY, SEWERAGE, DRAINAGE OR ELECTRIC POWER SUPPLY THAT MAY BE REQUIRED AS ASSESSED BY THE CONCERNED AUTHORITY, NAMELY, THE LOCAL BODY AND TAMIL NADU ELECTRICITY BOARD, SHALL BE BORNE BY THE APPLICANT.

LEGEND

- SITE BOUNDARY
- ROADS GIFTED TO LOCAL BODY
- EXISTING ROAD

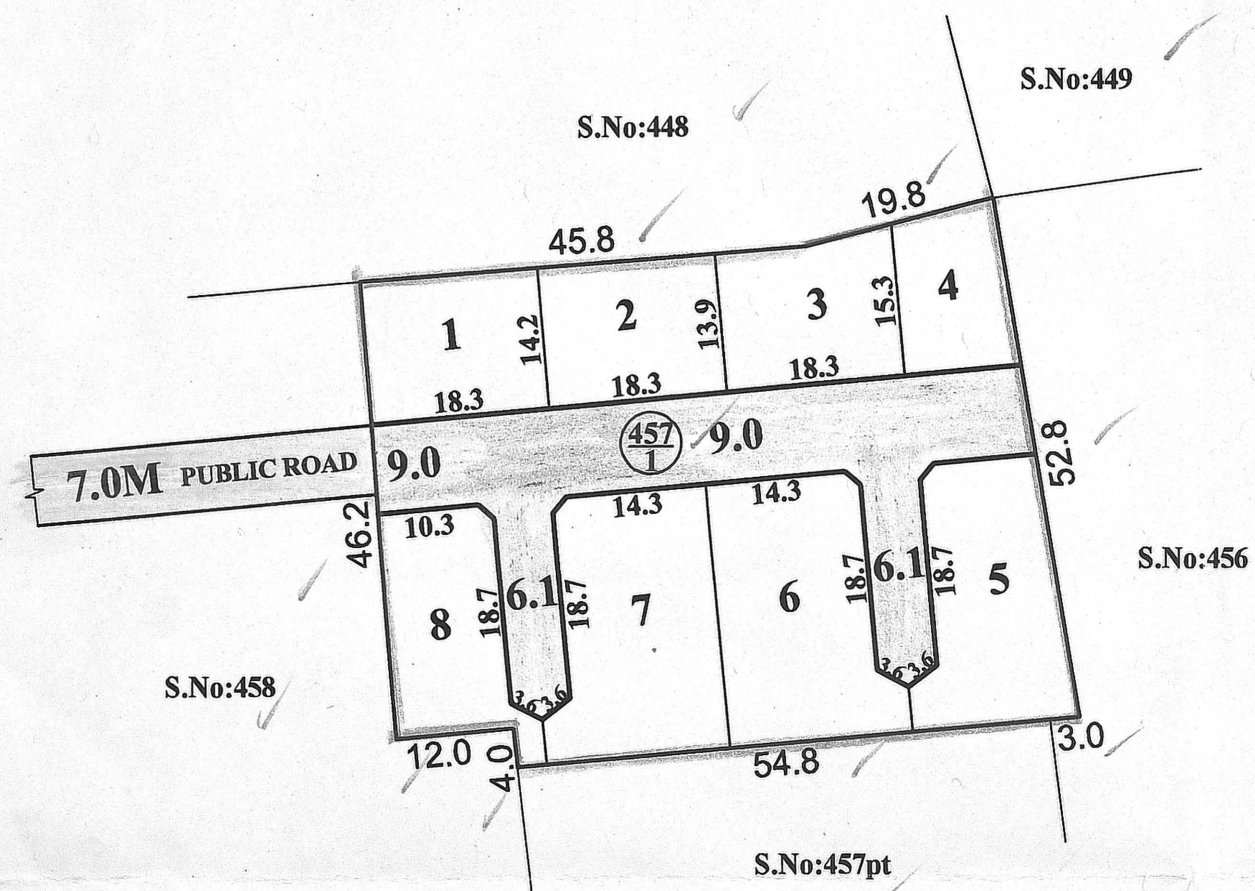

CONDITION:

THE SUB-DIVISION APPROVED IS VALID SUBJECT TO OBTAINING SANCTION FROM THE LOCAL BODY CONCERNED.

<u>P.P.D</u>	NO:	<u>128</u>
<u>L.O</u>		<u>2019</u>

APPROVED

VIDE LETTER NO : L1 / 15314 / 2019
 DATE : / 11 / 2019

PREPARED BY *S. Sundha* 22/11/19
 P.A.II *[Signature]* 22/11/19
 A.P. *[Signature]* 22/11/19

[Signature] 22/11/19
 FOR CHIEF PLANNER (MSB/LAYOUT)
 CHENNAI METROPOLITAN
 DEVELOPMENT AUTHORITY

POONAMALLEE PANCHAYAT UNION

SUB-DIVISION OF HOUSE SITES IN S.No: 457/1 OF THIRUNINDRAVUR 'B' VILLAGE.

SCALE : 1:800 (ALL MEASUREMENTS ARE IN METRE.)

